

# Proposed Portaferry Cohousing Master Plan

## M21-Port D39

Proposed Cohousing  
Development at Lands adj. to  
9-17, Cloughy Road,  
Portaferry.

### Master Plan

Portaferry Cohousing

- LANDSCAPING KEY**
- Existing buildings in context.
  - 9m Wayleave.
  - Flood risk area.
  - 100 Year flood risk area.
  - Pathways.
  - Parking areas/Low-traffic private service lanes.
  - Cohousing community growing area.
  - Wild flower areas.
  - Cohousing community orchard.
  - Existing Landscape Buffer Planted Spring 2022 (Small Woodland Grant Scheme).
  - Close boarded timber boundary fence (see fence detail).
  - Boundary wall (see wall detail).
  - Existing trees retained.
  - Proposed Trees.
  - Proposed Hedge Planting.
  - Orientation.
  - Front Entrance.

This drawing is scaled for Planning Service only and may be required accordingly, but no measurements should be scaled during the construction phase. Dimensions where given may be relied upon. If confirmation is required please contact Bell Architects Ltd.

© The Copyright rests with Bell Architects Ltd and / or their clients, this drawing or any part, must not be copied or reproduced in any way without consent of Bell Architects Ltd.

NO.	DATE	BY	CHECKED
1/500	21.12.2022	SK	

Rev.	Description	Date	Drawn by

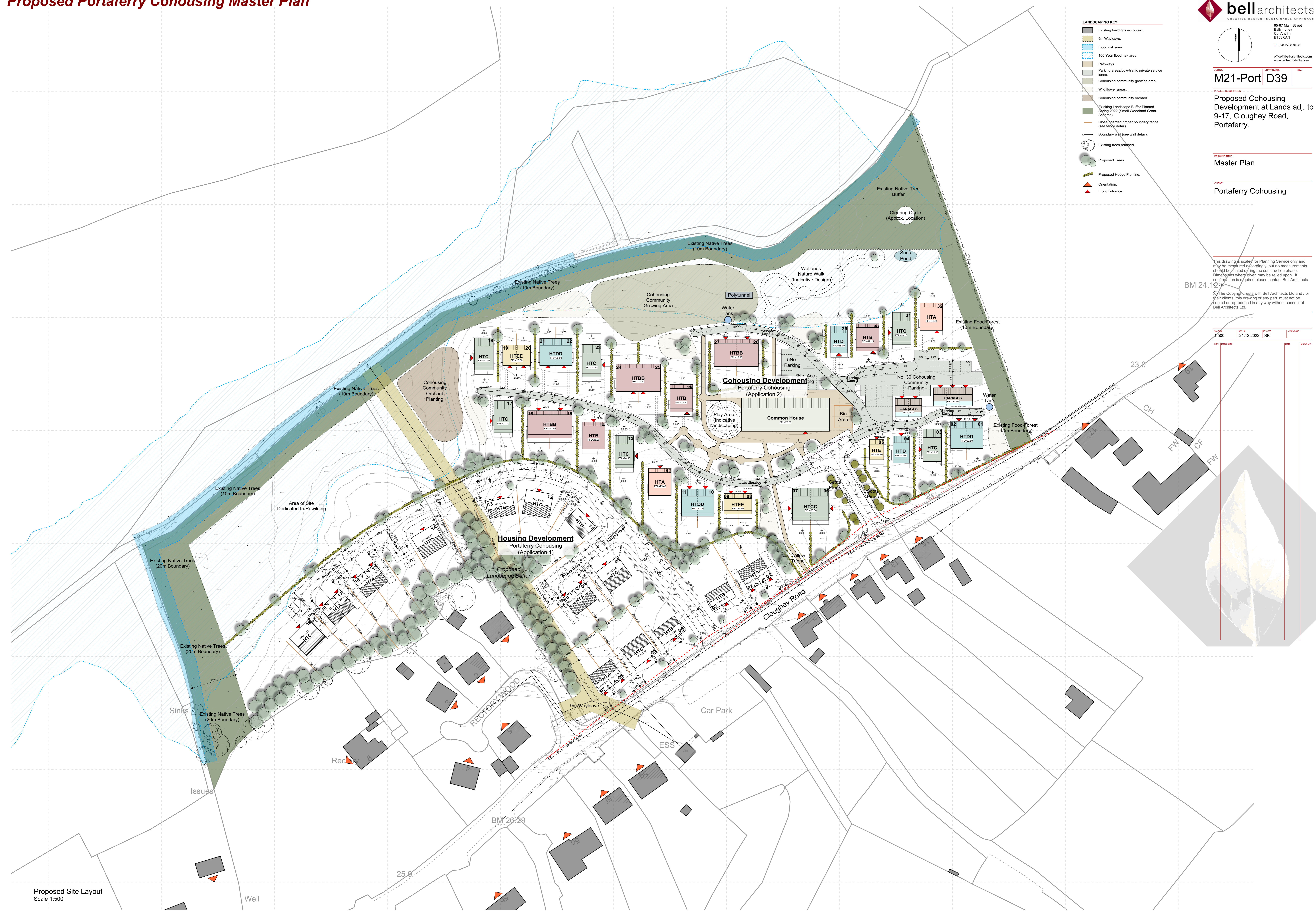

Proposed Site Layout  
Scale 1:500